

**Five-Disk Tumbler
Door & Drawer Cam Lock**

A001

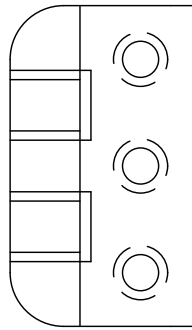

**S/S 5-Knuckle
Hospital Type Hinge**

JMPH.1

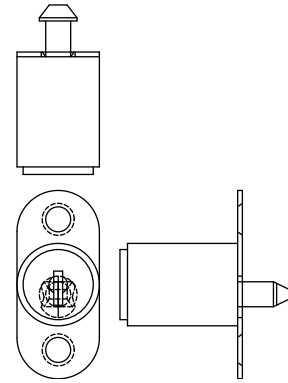

**Five-Disk Tumbler
Sliding Door Lock**

A003

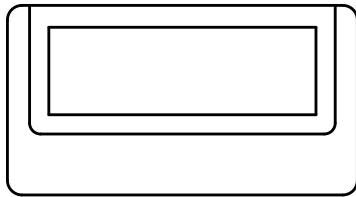

**Aluminum P.S.A.
Label Holder**

964

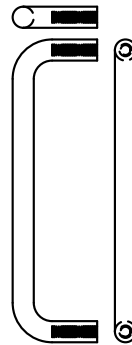

**Satin Chrome Plated
Sq. Bar Pull, 4" Centers**

00506010

**Stainless Steel
Sq. Bar Pull, 4" Centers**

90000391

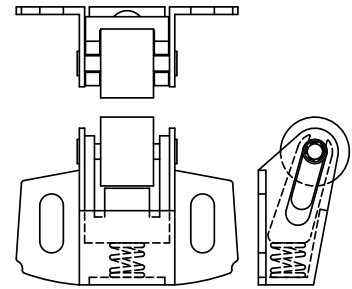

**Nylon Tired
Roller Catch**

02350410

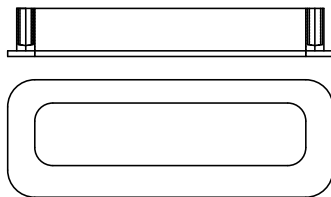

**Satin Chrome Plated
Recessed Flush Pull**

02450100

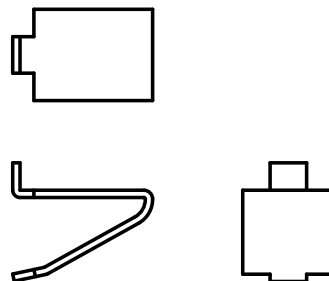

**K.V. #2392
Zinc Plated Shelf Clip**

960

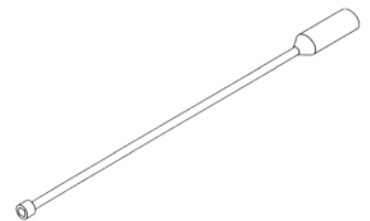

**Screw Drive Handle
Leveling Tool (18" long)**

A017

Casework Hardware & Accessories

Reagent Shelf Supports

4" Wide x 16" Tall
 Use on island or against wall
 Use with apron fronts for
 enclosed Reagent Rack System
 8", 12" and 16" deep

- P511-08
- P511-12
- P511-16

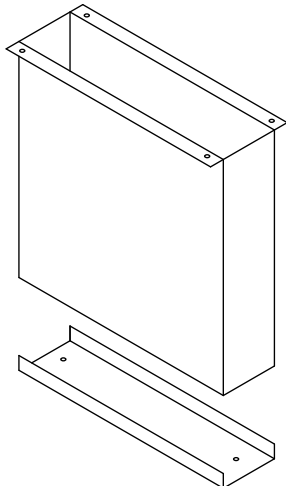

Strut Support For Pipe Chase

Adjustable height
 Use at island or against wall

Standing Height

- 34-1/4" High
- 512-07
- 512-08
- 512-13
- 512-14
- 512-20
- 512-26

Sitting Height

- 28" High
- 542-07
- 542-08
- 542-13
- 542-14
- 542-20
- 542-26

ADA Height

- 32" High
- 582-07
- 582-08
- 582-13
- 582-14
- 582-20
- 582-26

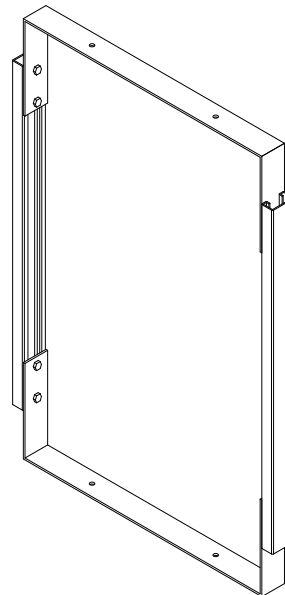

Pipe Chase

P509-24
 24" Wide x 6" Deep x 84" High

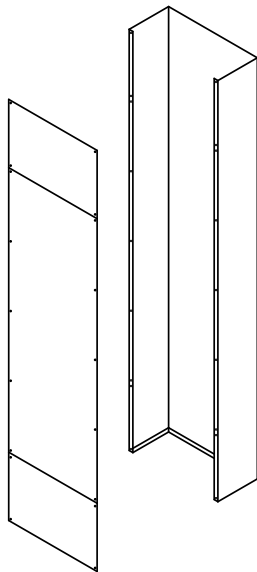

Caster Kit

- Stem for Table 962
- Caster Kit (6) 962-1