

**P & S Series Tall Cabinets - Storage**

83 1/2" High Plus 1" Maximum Adjustment of Leveling Bolts

Last two digits of catalog number indicate width. Example: P125-18.

Use the letter **S** in place of **P** for Stainless Steel. Example: **S**125-18.

Cabinets come standard with wire pull. To specify Recessed Pull, add **R** to end of cabinet number. Example: P125-18**R**.

For Locking Cabinet, add **L** to cabinet number. Example: P125-18**L**.

Please note: You must specify lock keying preferences when ordering locks; master keying and grand master keying may incur additional costs. Example: S125-18**RL** will order a stainless steel cabinet with recessed pulls and locks.

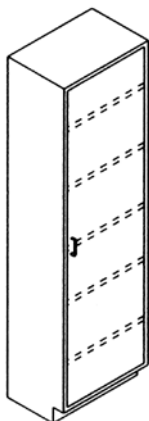

**Swing-Door Storage Unit; Five Adjustable Shelves; Hinged, Solid Door Panel**

**Tall Storage Cabinets - 16" Deep**

- P319-18
- P319-24

**Tall Storage Cabinets - 18" Deep**

- P330-18
- P330-24

**Tall Storage Cabinets - 22" Deep**

- P313-18
- P313-24

**Tall Storage Cabinets - 24" Deep**

- P340-18
- P340-24

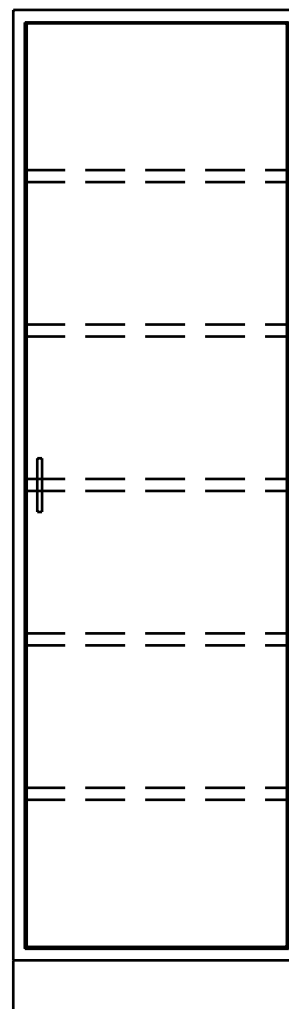

## P & S Series Tall Cabinets - Storage

83 1/2" High Plus 1" Maximum Adjustment of Leveling Bolts

Last two digits of catalog number indicate width. Example: P125-18.

Use the letter **S** in place of **P** (Painted) for Stainless Steel. Example: S125-18.

Cabinets come standard with wire pull. To specify Recessed Pull, add **R** to end of cabinet number. Example: P125-18**R**.

For Locking Cabinet, add **L** to cabinet number. Example: P125-18**L**.

Please note: You must specify lock keying preferences when ordering locks; master keying and grand master keying may incur additional costs. Example: S125-18**RL** will order a stainless steel cabinet with recessed pulls and locks.

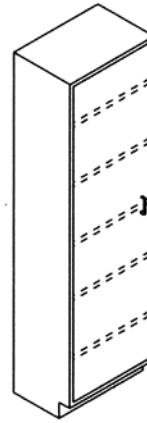

**Swing-Door Storage Unit; Five Adjustable Shelves; Hinged, Solid Door Panel**

### Tall Storage Cabinets-16" Deep

P320-18  
P320-24

### Tall Storage Cabinets-18" Deep

P331-18  
P331-24

### Tall Storage Cabinets-22" Deep

P314-18  
P314-24

### Tall Storage Cabinets-24" Deep

P341-18  
P341-24

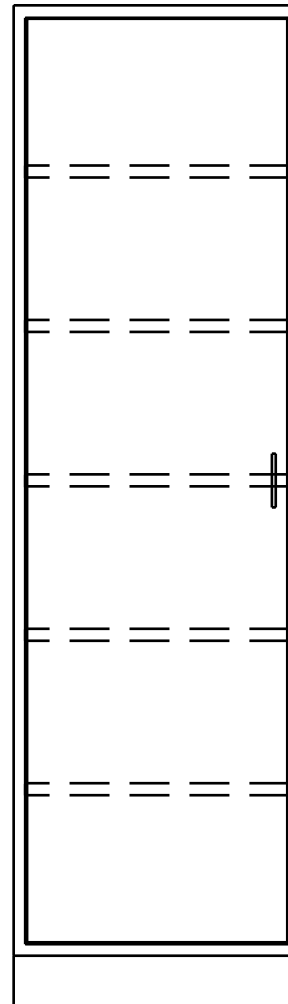

## P & S Series Tall Cabinets - Storage

83 1/2" High Plus 1" Maximum Adjustment of Leveling Bolts

Last two digits of catalog number indicate width. Example: P125-18.

Use the letter **S** in place of **P** for Stainless Steel. Example: **S**125-18.

Cabinets come standard with wire pull. To specify Recessed Pull, add **R** to end of cabinet number. Example: P125-18**R**.

For Locking Cabinet, add **L** to cabinet number. Example: P125-18**L**.

Please note: You must specify lock keying preferences when ordering locks; master keying and grand master keying may incur additional costs. Example: S125-18**RL** will order a stainless steel cabinet with recessed pulls and locks.

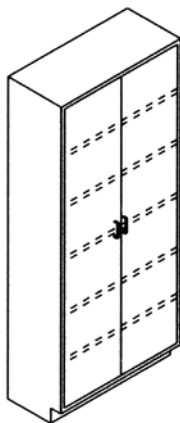

**Swing-Door Storage Unit; Five Adjustable Shelves; Hinged, Solid Door Panel**

### Tall Storage Cabinets - 16" Deep

P353-30  
P353-36  
P353-42  
P353-48

### Tall Storage Cabinets - 18" Deep

P332-30  
P332-36  
P332-42  
P332-48

### Tall Storage Cabinets - 22" Deep

P303-30  
P303-36  
P303-42  
P303-48

### Tall Storage Cabinets - 24" Deep

P342-30  
P342-36  
P342-42  
P342-48

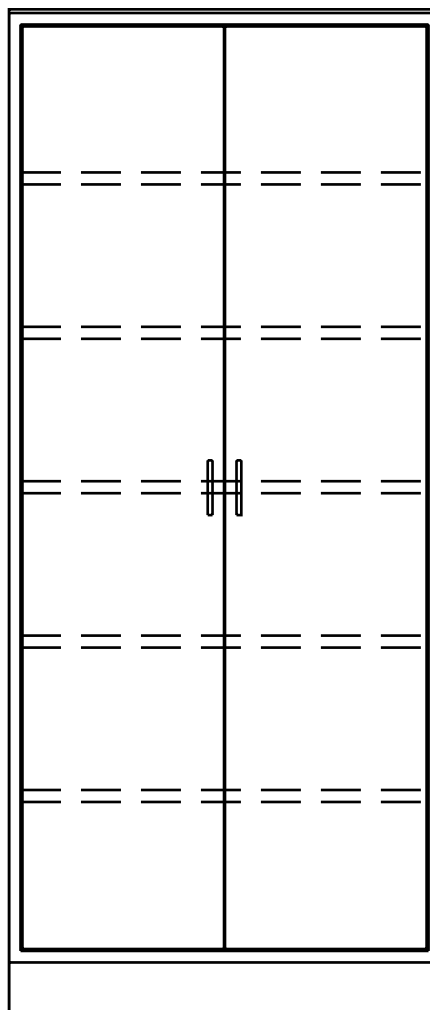

## **P & S Series Tall Cabinets – Storage**

83 1/2" High Plus 1" Maximum Adjustment of Leveling Bolts

Last two digits of catalog number indicate width. Example: P125-**18**.

Use the letter **S** in place of **P** (Painted) for Stainless Steel. Example: **S**125-18.

Cabinets come standard with wire pull. To specify Recessed Pull, add **R** to end of cabinet number. Example: P125-18**R**.

For Locking Cabinet, add **L** to cabinet number. Example: P125-18**L**.

Please note: You must specify lock keying preferences when ordering locks; master keying and grand master keying may incur additional costs. Example: S125-18**RL** will order a stainless steel cabinet with recessed pulls and locks.

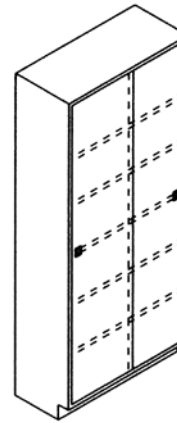

**Sliding-Door Storage Unit; Five Adjustable Shelves; Flush Pulls; Solid Door Panel**

### **Tall Storage Cabinets – 16" Deep**

P355-30  
P355-36  
P355-42  
P355-48

### **Tall Storage Cabinets – 18" Deep**

P336-30  
P336-36  
P336-42  
P336-48

### **Tall Storage Cabinets – 22" Deep**

P305-30  
P305-36  
P305-42  
P305-48

### **Tall Storage Cabinets – 24" Deep**

P346-30  
P346-36  
P346-42  
P346-48

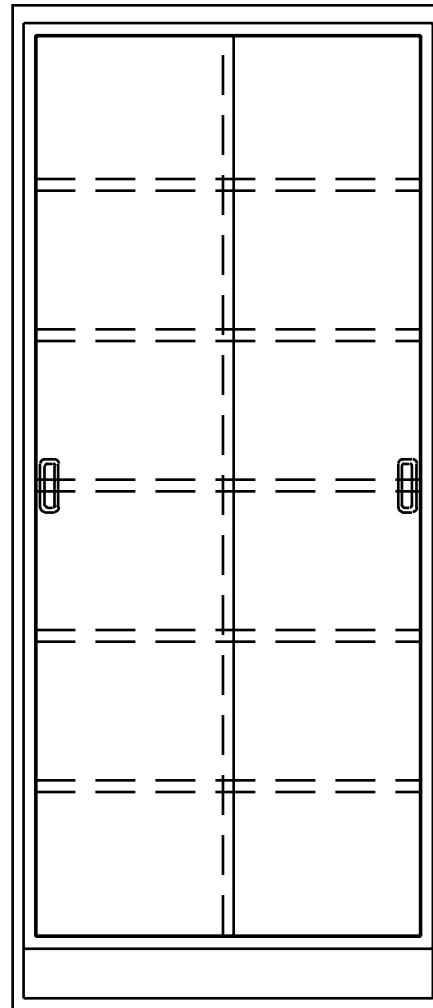

**P & S Series Tall Cabinets - Storage**

83 1/2" High Plus 1" Maximum Adjustment of Leveling Bolts

Last two digits of catalog number indicate width. Example: P125-18.

Use the letter **S** in place of **P** for Stainless Steel. Example: **S**125-18.

Cabinets come standard with wire pull. To specify Recessed Pull, add **R** to end of cabinet number. Example: P125-18**R**.

For Locking Cabinet, add **L** to cabinet number. Example: P125-18**L**.

Please note: You must specify lock keying preferences when ordering locks; master keying and grand master keying may incur additional costs. Example: S125-18**RL** will order a stainless steel cabinet with recessed pulls and locks.

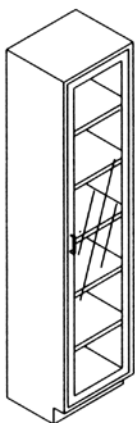

**Glass Door Storage Unit; Glazed Glass Door; Five Adjustable Shelves; 1/4" Float Glass**

**Tall Storage Cabinets - 16" Deep**

- P321-18
- P321-24

**Tall Storage Cabinets - 18" Deep**

- P333-18
- P333-24

**Tall Storage Cabinets - 22" Deep**

- P315-18
- P315-24

**Tall Storage Cabinets - 24" Deep**

- P343-18
- P343-24

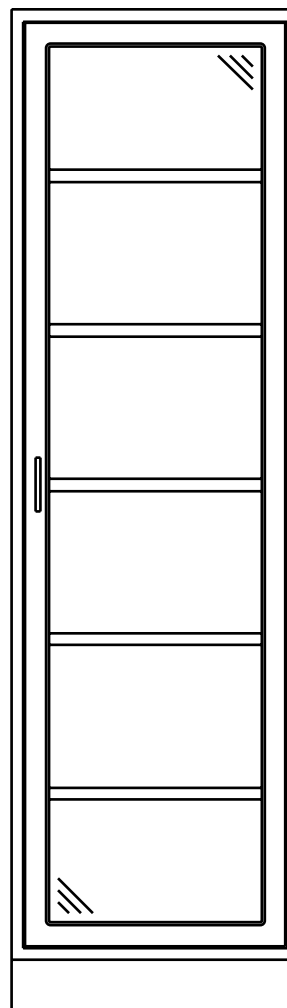

## **P & S Series Tall Cabinets – Storage**

83 1/2" High Plus 1" Maximum Adjustment of Leveling Bolts

Last two digits of catalog number indicate width. Example: P125-**18**.

Use the letter **S** in place of **P** (Painted) for Stainless Steel. Example: **S**125-18.

Cabinets come standard with wire pull. To specify Recessed Pull, add **R** to end of cabinet number. Example: P125-18**R**.

For Locking Cabinet, add **L** to cabinet number. Example: P125-18**L**.

Please note: You must specify lock keying preferences when ordering locks; master keying and grand master keying may incur additional costs. Example: S125-18**RL** will order a stainless steel cabinet with recessed pulls and locks.

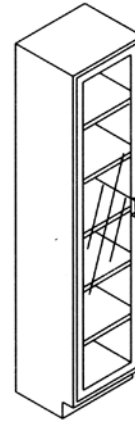

**Glass Door Storage Unit; Glazed Glass Door;  
Five Adjustable Shelves; 1/4" Float Glass**

### **Tall Storage Cabinets – 16" Deep**

P322-18

P322-24

### **Tall Storage Cabinets – 18" Deep**

P334-18

P334-24

### **Tall Storage Cabinets – 22" Deep**

P316-18

P316-24

### **Tall Storage Cabinets – 24" Deep**

P344-18

P344-24

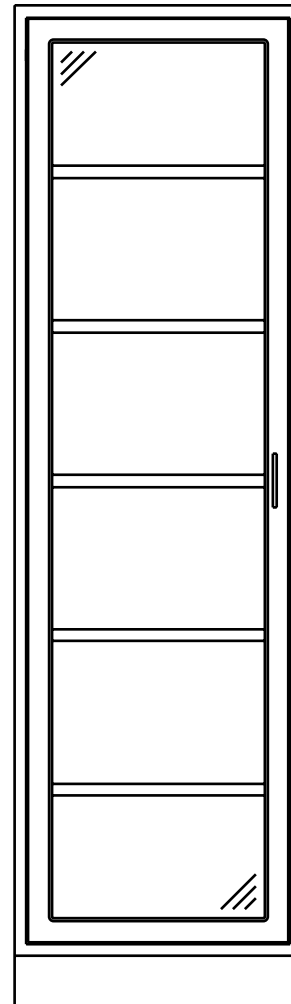

## P & S Series Tall Cabinets - Storage

83 1/2" High Plus 1" Maximum Adjustment of Leveling Bolts

Last two digits of catalog number indicate width. Example: P125-18.

Use the letter **S** in place of **P** for Stainless Steel. Example: **S**125-18.

Cabinets come standard with wire pull. To specify Recessed Pull, add **R** to end of cabinet number. Example: P125-18**R**.

For Locking Cabinet, add **L** to cabinet number. Example: P125-18**L**.

Please note: You must specify lock keying preferences when ordering locks; master keying and grand master keying may incur additional costs. Example: S125-18**RL** will order a stainless steel cabinet with recessed pulls and locks.

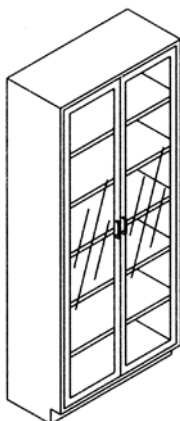

**Glass Door Storage Unit; Glazed Glass Door; Five Adjustable Shelves; 1/4" Float Glass**

### Tall Storage Cabinets - 16" Deep

P357-30  
P357-36  
P357-42  
P357-48

### Tall Storage Cabinets - 18" Deep

P335-30  
P335-36  
P335-42  
P335-48

### Tall Storage Cabinets - 22" Deep

P307-30  
P307-36  
P307-42  
P307-48

### Tall Storage Cabinets - 24" Deep

P345-30  
P345-36  
P345-42  
P345-48

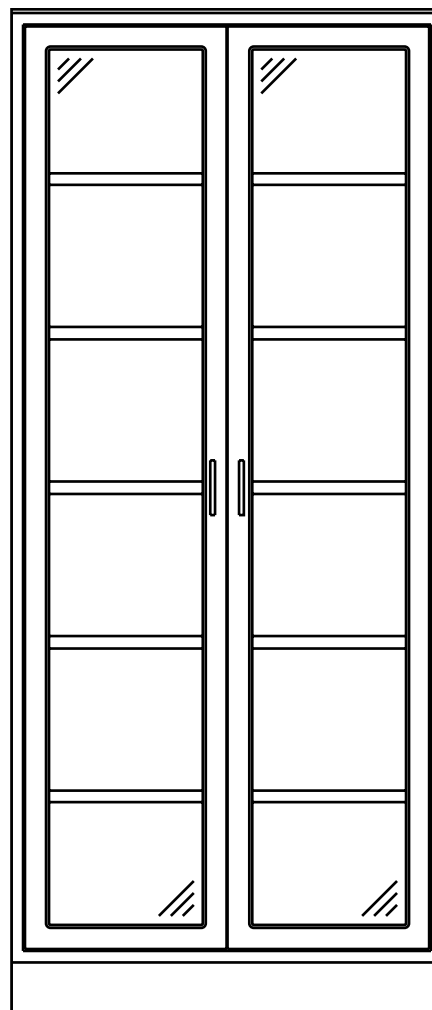

## **P & S Series Tall Cabinets – Storage**

83 1/2" High Plus 1" Maximum Adjustment of Leveling Bolts

Last two digits of catalog number indicate width. Example: P125-**18**.

Use the letter **S** in place of **P** (Painted) for Stainless Steel. Example: **S**125-18.

Cabinets come standard with wire pull. To specify Recessed Pull, add **R** to end of cabinet number. Example: P125-18**R**.

For Locking Cabinet, add **L** to cabinet number. Example: P125-18**L**.

Please note: You must specify lock keying preferences when ordering locks; master keying and grand master keying may incur additional costs. Example: S125-18**RL** will order a stainless steel cabinet with recessed pulls and locks.

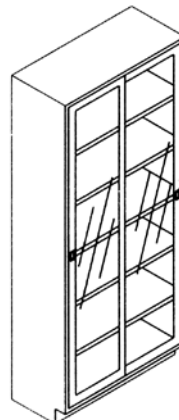

**Glass Door Storage Unit; Glazed Glass Door; Five Adjustable Shelves; 1/4" Float Glass; Flush Pulls**

### **Tall Storage Cabinets – 16" Deep**

P358-30  
P358-36  
P358-42  
P358-48

### **Tall Storage Cabinets – 18" Deep**

P337-30  
P337-36  
P337-42  
P336-48

### **Tall Storage Cabinets – 22" Deep**

P308-30  
P308-36  
P308-42  
P308-48

### **Tall Storage Cabinets – 24" Deep**

P347-30  
P347-36  
P347-42  
P347-48

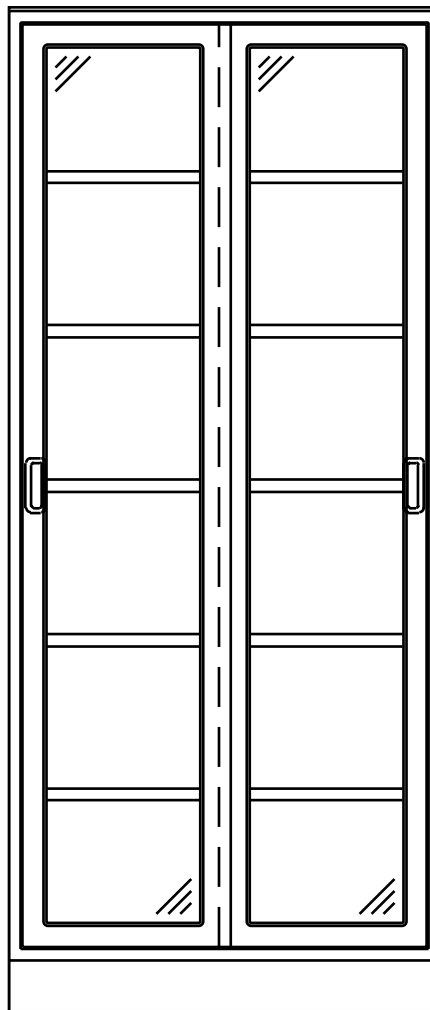

## P & S Series Tall Cabinets - Storage

83 1/2" High Plus 1" Maximum Adjustment of Leveling Bolts

Last two digits of catalog number indicate width. Example: P125-18.

Use the letter **S** in place of **P** for Stainless Steel. Example: **S**125-18.

Cabinets come standard with wire pull. To specify Recessed Pull, add **R** to end of cabinet number. Example: P125-18**R**.

For Locking Cabinet, add **L** to cabinet number. Example: P125-18**L**.

Please note: You must specify lock keying preferences when ordering locks; master keying and grand master keying may incur additional costs. Example: S125-18**RL** will order a stainless steel cabinet with recessed pulls and locks.

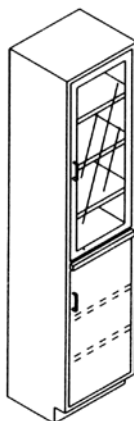

**Instrument Storage Unit; Glazed Glass Door Upper with Three Hinges; 1/4" Float Glass; Solid Door Panels at Lower Opening with Two Hinges; Stainless Steel Pullout Shelf; Five Adjustable Shelves**

### Tall Storage Cabinets - 16" Deep

P323-18

P323-24

### Tall Storage Cabinets - 18" Deep

P361-18

P361-24

### Tall Storage Cabinets - 22" Deep

P317-18

P317-24

### Tall Storage Cabinets - 24" Deep

P364-18

P364-24

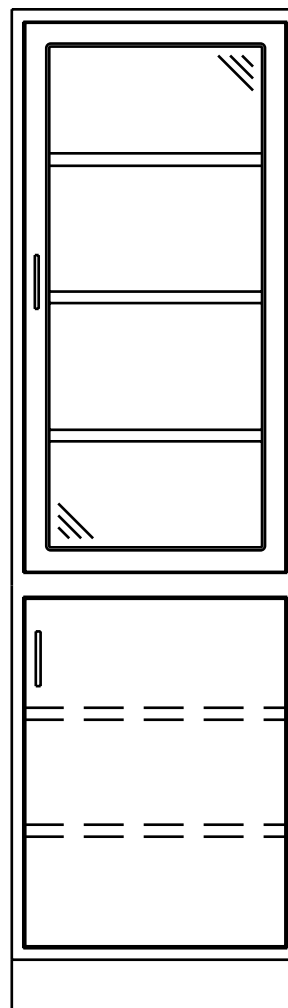

## P & S Series Tall Cabinets - Storage

83 1/2" High Plus 1" Maximum Adjustment of Leveling Bolts

Last two digits of catalog number indicate width. Example: P125-18.

Use the letter **S** in place of **P** (Painted) for Stainless Steel. Example: S125-18.

Cabinets come standard with wire pull. To specify Recessed Pull, add **R** to end of cabinet number. Example: P125-18**R**.

For Locking Cabinet, add **L** to cabinet number. Example: P125-18**L**.

Please note: You must specify lock keying preferences when ordering locks; master keying and grand master keying may incur additional costs. Example: S125-18**RL** will order a stainless steel cabinet with recessed pulls and locks.

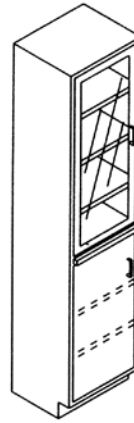

**Instrument Storage Unit; Glazed Glass Door Upper with Three Hinges; 1/4" Float Glass; Solid Door Panels at Lower Opening with Two Hinges; Stainless Steel Pullout Shelf; Five Adjustable Shelves**

### Tall Storage Cabinets - 16" Deep

P324-18  
P324-24

### Tall Storage Cabinets - 18" Deep

P362-18  
P362-24

### Tall Storage Cabinets - 22" Deep

P318-18  
P318-24

### Tall Storage Cabinets - 24" Deep

P365-18  
P365-24

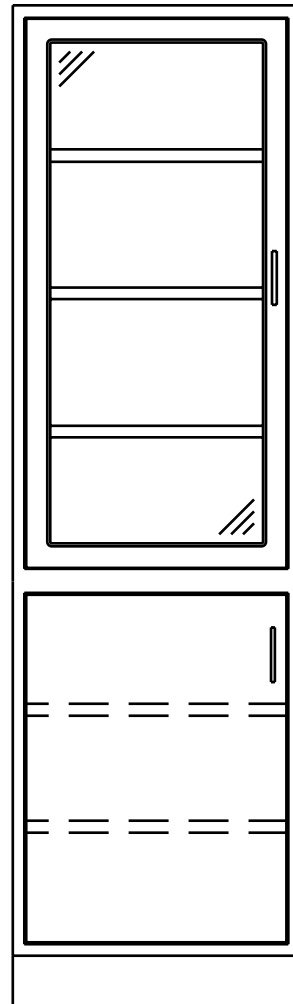

## P & S Series Tall Cabinets - Storage

83 1/2" High Plus 1" Maximum Adjustment of Leveling Bolts

Last two digits of catalog number indicate width. Example: P125-18.

Use the letter **S** in place of **P** for Stainless Steel. Example: **S**125-18.

Cabinets come standard with wire pull. To specify Recessed Pull, add **R** to end of cabinet number. Example: P125-18**R**.

For Locking Cabinet, add **L** to cabinet number. Example: P125-18**L**.

Please note: You must specify lock keying preferences when ordering locks; master keying and grand master keying may incur additional costs. Example: S125-18**RL** will order a stainless steel cabinet with recessed pulls and locks.

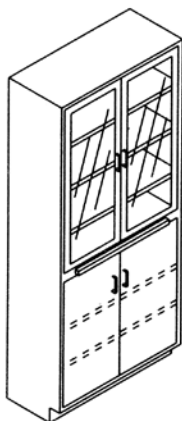

**Instrument Storage Unit; Glazed Glass Door Upper with Three Hinges; 1/4" Float Glass; Solid Door Panels at Lower Opening with Two Hinges; Stainless Steel Pullout Shelf; Five Adjustable Shelves**

### Tall Storage Cabinets - 16" Deep

P359-30  
P359-36  
P359-42  
P359-48

### Tall Storage Cabinets - 18" Deep

P363-30  
P363-36  
P363-42  
P363-48

### Tall Storage Cabinets - 22" Deep

P309-30  
P309-36  
P309-42  
P309-48

### Tall Storage Cabinets - 24" Deep

P366-30  
P366-36  
P366-42  
P366-48

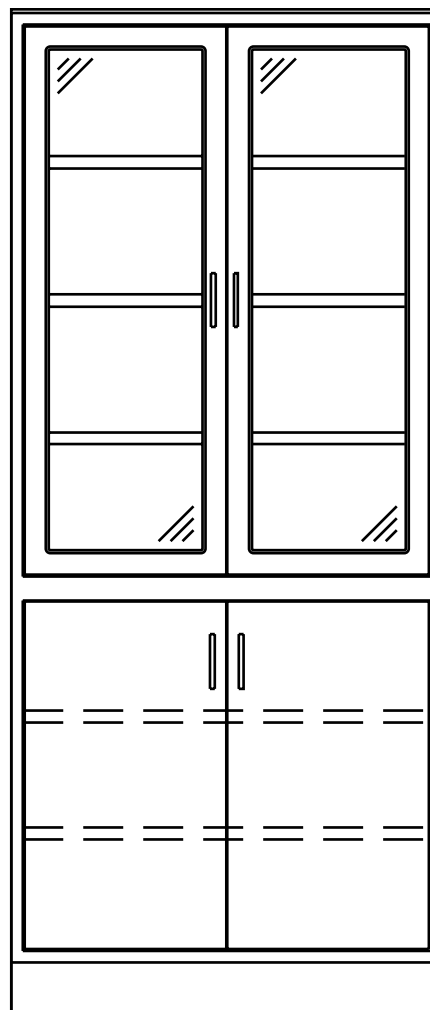

## **P & S Series Tall Cabinets – Storage**

83 1/2" High Plus 1" Maximum Adjustment of Leveling Bolts

Last two digits of catalog number indicate width. Example: P125-18.

Use the letter **S** in place of **P** (Painted) for Stainless Steel. Example: **S**125-18.

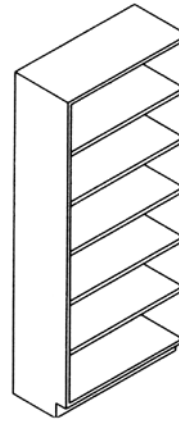

**Open Front Storage Unit;  
Five Adjustable Shelves**

### **Tall Storage Cabinets – 16" Deep**

P351-18  
P351-24  
P351-30  
P351-36  
P351-42  
P351-48

### **Tall Storage Cabinets – 18" Deep**

P338-18  
P338-24  
P338-30  
P338-36  
P338-42  
P338-48

### **Tall Storage Cabinets – 22" Deep**

P301-18  
P301-24  
P301-30  
P301-36  
P301-42  
P301-48

### **Tall Storage Cabinets – 24" Deep**

P348-18  
P348-24  
P348-30  
P348-36  
P348-42  
P348-48

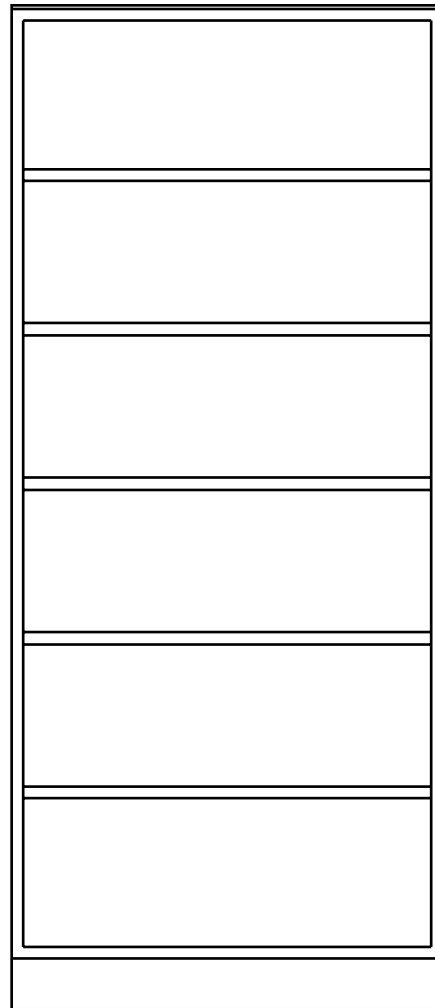

## P & S Series Tall Cabinets - Wardrobe

83 1/2" High Plus 1" Maximum Adjustment of Leveling Bolts

Last two digits of catalog number indicate width. Example: P125-18.

Use the letter **S** in place of **P** for Stainless Steel. Example: **S**125-18.

Cabinets come standard with wire pull. To specify Recessed Pull, add **R** to end of cabinet number. Example: P125-18**R**.

For Locking Cabinet, add **L** to cabinet number. Example: P125-18**L**.

Please note: You must specify lock keying preferences when ordering locks; master keying and grand master keying may incur additional costs. Example: S125-18**RL** will order a stainless steel cabinet with recessed pulls and locks.

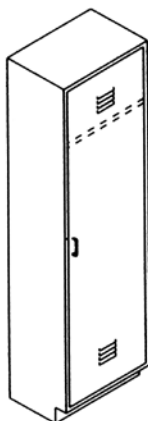

**Single Wardrobe Unit; Hat Shelf;  
Coat Rod; Louvered Door**

### Tall Storage Cabinets - 16" Deep

P670-18

P670-24

### Tall Storage Cabinets - 18" Deep

P673-18

P673-24

### Tall Storage Cabinets - 22" Deep

P623-18

P623-24

### Tall Storage Cabinets - 24" Deep

P676-18

P676-24

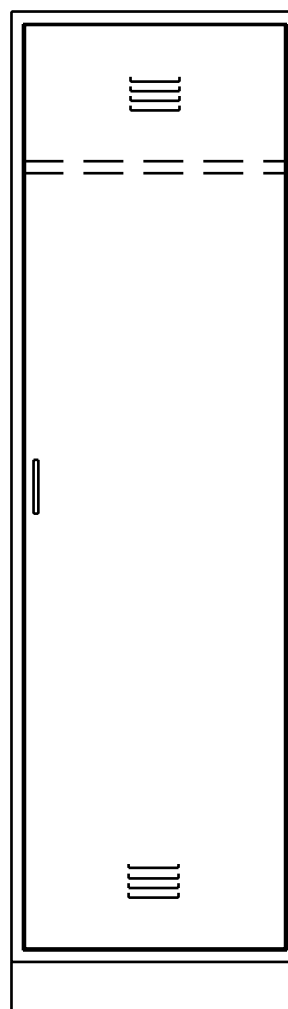

## P & S Series Tall Cabinets - Wardrobe

83 1/2" High Plus 1" Maximum Adjustment of Leveling Bolts

Last two digits of catalog number indicate width. Example: P125-18.

Use the letter **S** in place of **P** (Painted) for Stainless Steel. Example: S125-18.

Cabinets come standard with wire pull. To specify Recessed Pull, add **R** to end of cabinet number. Example: P125-18**R**.

For Locking Cabinet, add **L** to cabinet number. Example: P125-18**L**.

Please note: You must specify lock keying preferences when ordering locks; master keying and grand master keying may incur additional costs. Example: S125-18**RL** will order a stainless steel cabinet with recessed pulls and locks.

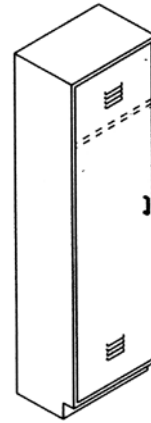

**Single Wardrobe Unit; Hat Shelf;  
Coat Rod; Louvered Door**

### Tall Storage Cabinets - 16" Deep

P671-18

P671-24

### Tall Storage Cabinets - 18" Deep

P674-18

P674-24

### Tall Storage Cabinets - 22" Deep

P624-18

P624-24

### Tall Storage Cabinets - 24" Deep

P677-18

P677-24

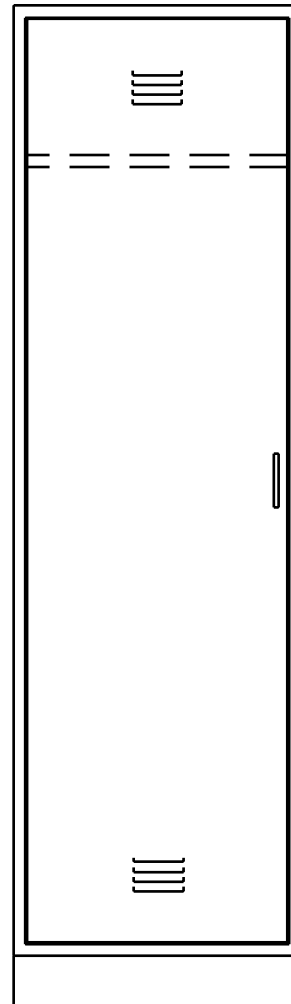

## P & S Series Tall Cabinets - Wardrobe

83 1/2" High Plus 1" Maximum Adjustment of Leveling Bolts

Last two digits of catalog number indicate width. Example: P125-18.

Use the letter **S** in place of **P** for Stainless Steel. Example: **S**125-18.

Cabinets come standard with wire pull. To specify Recessed Pull, add **R** to end of cabinet number. Example: P125-18**R**.

For Locking Cabinet, add **L** to cabinet number. Example: P125-18**L**.

Please note: You must specify lock keying preferences when ordering locks; master keying and grand master keying may incur additional costs. Example: S125-18**RL** will order a stainless steel cabinet with recessed pulls and locks.

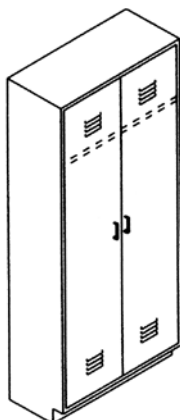

**Double Wardrobe Unit; Full-Width Hat Shelf;  
Coat Rod; Louvered Door**

### Tall Storage Cabinets - 16" Deep

P672-30  
P672-36  
P672-42  
P672-48

### Tall Storage Cabinets - 18" Deep

P675-30  
P675-36  
P675-42  
P675-48

### Tall Storage Cabinets - 22" Deep

P622-30  
P622-36  
P622-42  
P622-48

### Tall Storage Cabinets - 24" Deep

P678-30  
P678-36  
P678-42  
P678-48

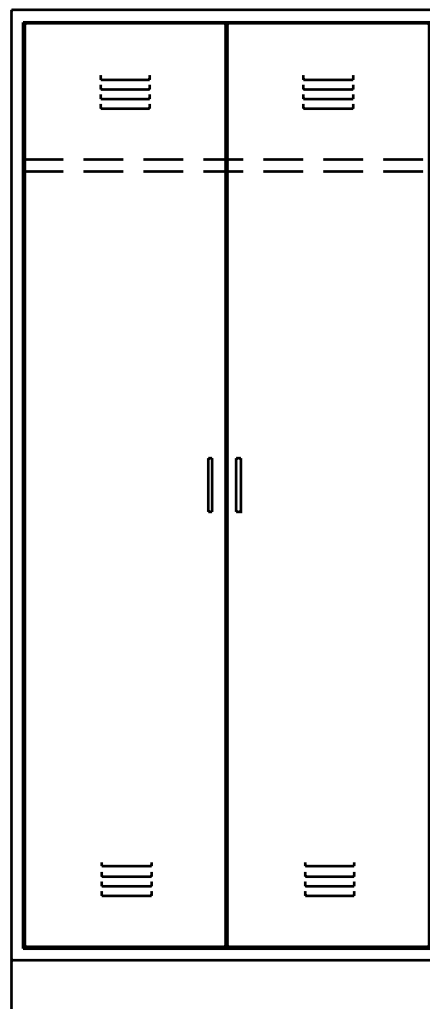

**This page was intentionally left blank.**